



Installation Guide

DEVIreg™ 531

Electronic Thermostat

Table of Contents

1	Introduction	3
	1.1 Technical Specifications	4
	1.2 Safety Instructions	5
2	Mounting Instructions	6
3	Warranty	10
4	Disposal Instruction	10

1 Introduction

DEVIreg™ 531 is an electronic thermostat provided with a 2-pole switch and a room sensor to measure and control the desired air temperature. It can be either flush-mounted or surface-mounted.

The thermostat has a button for adjusting the temperature setting with a scale from () 5-35°C. Furthermore, it has a LED indicator showing standby periods (green light) and heating periods (red light).

More information on this product can also be found at:
devireg.devi.com

1.1 Technical Specifications

Operation voltage	220-240V~, 50Hz
Standby power consumption	Max 0.25W
Relay: Resistive load Inductive load	Max 15A / 3450W @ 230V cos φ= 0.3 max 1A
Sensing units	NTC 15kOhm at 25°C
Sensing values:	
0°C	42 kOhm
25°C	15 kOhm
50°C	6 kOhm
Hysteresis	± 0.2°C
Ambient temperature	-10 to +30°C
Frost protection temperature	5°C - ❄
Temperature range	(❄) 5-35°C with room sensor
Cable specification max	1x4mm ² or 2x2,5mm ²
Ball pressure temperature	75°C
Pollution degree	2 (domestic use)

Type	1C
Storage temperature	-20 to +65°C
IP class	31
Protection class	Class II - 
Dimensions	85 x 85 x 36mm
Weight	90g

The product complies with the EN/IEC Standard "Automatic electrical controls for household and similar use":

- EN/IEC 60730-1 (general)
- EN/IEC 60730-2-9 (thermostat)

1.2 Safety Instructions

Make sure the mains supply to the thermostat is turned off before installation.

IMPORTANT: When the thermostat is used to control a floor heating element in connection with a wooden floor or similar material, always use a floor sensor and never set the maximum floor temperature to more than 35°C.

Please also note the following:

- The installation of the thermostat must be done by an authorized and qualified installer according to local regulations.
- The thermostat must be connected to a power supply via an all-pole disconnection switch.
- Always connect the thermostat to continuous power supply.
- Do not expose the thermostat to moisture, water, dust, and excessive heat.

2 Mounting Instructions

Please observe the following placement guidelines:

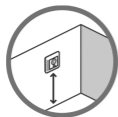

Place the thermostat at a suitable height on the wall (typically 80-170cm.).



In wet rooms, always place the thermostat according to local regulation on IP classes.

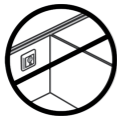

Do not place the thermostat on the inner side of an exterior wall.



Always install the thermostat at least 50 cm. from windows and doors.

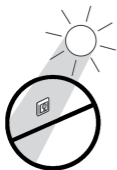

Do not place the thermostat in a way that it will be exposed to direct sunlight.

Follow the steps below to mount the thermostat:

1. Open the thermostat:

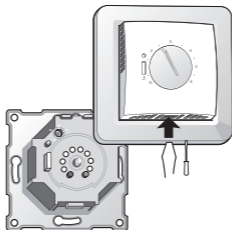

- Press the release tab in the bottom of the thermostat using a flat object.
- Carefully detach the front cover.
- Carefully detach the frame.

2. Connect the thermostat according to the connection diagram.

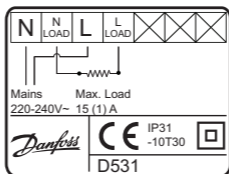

The screen of the heating cable must be connected to the earth conductor of the power supply cable by using a separate connector.

Note: Always install the floor sensor in a conduit in the floor.

3. Mount and reassemble the thermostat:
 - Fasten the thermostat to a socket or an exterior wall box by driving the screws through the holes in each side of the thermostat.
 - Install the frame and front cover in the reverse order of disassembly.
4. Turn on the power supply.

3 **Warranty**



4 **Disposal Instruction**



Danfoss A/S
Electric Heating Systems
Ulvehavevej 61
7100 Vejle
Denmark
Phone: +45 7488 8500
Fax: +45 7488 8501
E-mail: EH@DEVI.com
www.DEVI.com

Danfoss can accept no responsibility for possible errors in catalogues, brochures and other printed material. Danfoss reserves the right to alter its products without notice. This also applies to products already on order provided that such alterations can be made without subsequential changes being necessary in specifications already agreed. All trademarks in this material are property of the respective companies. DEVI and the DEVI logo-type are trademarks of Danfoss A/S. All rights reserved.

DEVireg 531 ELKO

140F1034

Thermostat
- Room Sensor
220-240V~
50-60Hz~
+5 to +35°C
15A/3450W@230V~
IP 31

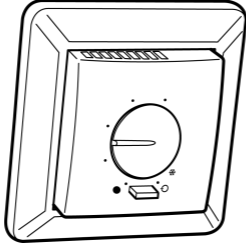

Product Documentation

Designed in Denmark for Danfoss A/S

